



Regional Municipality of Halton

**New North Oakville Transportation
Corridor and Crossing of Sixteen Mile
Creek**

**Appendix B-3.2: TAC Meeting #2 -
April 12, 2005**



REGIONAL MUNICIPALITY OF HALTON
NEW BURNHAMTHORPE ROAD (REGIONAL
ROAD 27) TRANSPORTATION CORRIDOR AND
POTENTIAL FUTURE BRIDGE CROSSING OF
SIXTEEN MILE CREEK

CLASS EA

TECHNICAL AGENCIES COMMITTEE MEETING #2
MEETING SUMMARY

APRIL 12, 2005
REGION OF HALTON ADMINISTRATIVE OFFICES
OAKVILLE, ON

This meeting summary was prepared by TSH and ENVision...synergy. It presents the key discussion points and outcomes from the April 13, 2005 Burnhamthorpe Road Stakeholder Group meeting #2 hosted by The Regional Municipality of Halton and is subject to review by meeting participants. It does not attribute comments to any particular participant. Comments and questions have been grouped as appropriate, by thematic areas. No attempt was made during the meeting to achieve consensus or agreement. If you have any questions or comments regarding the report, please contact:

Colleen Goodchild
TSH
300 Water Street
Whitby, ON L1N 9J2
Phone: (905) 668-9363
Fax: (905) 668-0221
cgoodchild@tsh.ca

1. ABOUT THE NEW BURNHAMTHORPE ROAD CORRIDOR AND POTENTIAL FUTURE CROSSING OF SIXTEEN MILE CREEK TECHNICAL AGENCIES COMMITTEE MEETING

The Region of Halton has initiated a Class Environmental Assessment for a new transportation corridor in the vicinity of Burnhamthorpe Road (Regional Road 27) to satisfy east-west travel demands in the Town of Oakville in October 2004. This study is being undertaken as a “Municipal Class Environmental Assessment (Class EA)”¹ under Ontario’s Environmental Assessment Act and follows the Schedule C provisions as set out in the June 2000 MEA Municipal Class EA document.²

The second meeting of the Class EA Technical Agencies Committee was hosted by the Regional Municipality of Halton to provide a planning context for the Study, to present the existing and future transportation conditions, and to identify transportation need, preliminary alternative solutions and assessment criteria.

Sixteen people attended the meeting, including representatives from municipal, transit, conservation and hydro organizations. The list of participants is included in Appendix A.

2. Background Information

2.1 Welcome and Introductions

Mike Delsey, TSH – Consultant Project Manager welcomed the group, acknowledging Regional Project Team staff and Charlotte Young, facilitator.

2.2 Presentation

Mike Delsey presented an overview of the project work completed to date to the TAC members. Mike discussed the study approach including:

- organization of the Study process including the public consultation component;
- scope of the study and study area characteristics;
- preliminary identification of study issues;
- transportation issues and opportunities/identification of need;
- preliminary alternatives solutions; and
- preliminary assessment criteria.

¹ A “Class Environmental Assessment” is the term used to describe a provincially legislated process for approval of municipal projects that have similar and predictable impacts, are usually of similar scale and nature and where measures can be taken to reduce or eliminate negative consequences (e.g., mitigative measures). For instance, there are Class EAs for municipal projects such as roads and sewers, Class EAs for forest management activities, and Class EAs for activities undertaken by the Ontario Realty Board for real estate activities. For more information regarding the Municipal Class EA, please reference the Municipal Engineer’s Association “Municipal Class Environmental Assessment” Guide.

² Projects that adhere to Schedule C requirements are those that have the potential for more significant environmental effects. Schedule C projects require a greater level of detail of study and preparation of an “Environmental Study Report (ESR)” that is available for public review.

The Committee raised a number of questions in response to the presentation and the Study. Committee questions and corresponding responses from the Project Team were as follows:

| Question | Response |
|--|--|
| <i>Planning Context/Greenspace Plan</i> | |
| Have you used the MNR greenspace announcement map to show the greenspace protection? No firm boundary mapping has been released by the province. | The Region used the mapping from the announcement and digitized the boundaries, then overlaid the layer in the Region's geographic information system (GIS). |
| How will the greenspace protection of the former Oakville Land Assembly lands (OLA) impact the need for a Burnhamthorpe Road and the elements of the Secondary Plan? | A number of scenarios were analyzed, including the removal of population and employment from the ORC lands and the redistribution of the ORC lands population and employment to other areas in North Oakville. The model results indicate that there is still a need for additional east-west capacity in the Study Area. |
| <i>Transportation Issues and Opportunities</i> | |
| Does the future transportation network include a Burnhamthorpe Road crossing of Sixteen Mile Creek? | The travel demand forecasting modelling work assumed a future road network that did not include a crossing of Sixteen Mile Creek but did include other network improvements such as improvements to Regional Road 5 (HOV lanes) and the extension of the James Snow Parkway to Neyagawa Boulevard. |
| Have you considered including a Lower Baseline connection? | The travel demand forecasting modelling work includes the link [Lower Baseline] as part of the overall network with its existing configuration and capacity. A Lower Baseline connection will be considered during the assessment of alternative solutions. |
| A screenline, to measure the volume to capacity ratio at the Oakville/Mississauga boundary, should be added to the analysis. | A screenline will be added. |
| <i>Oakville Transportation Master Plan</i> | |
| Did the volume-to-capacity ratios developed for the Study Area take into account provision of High Occupancy Vehicle lanes (HOV) or reserved bus lanes? | Yes, the travel demand forecasting model includes one lane of traffic in each direction on a widened Dundas Street as HOV. |
| What kind of transit mode split will Oakville achieve with the proposed transit network? | The overall ridership is anticipated to rise to 6 times the current rate. The mode split (% of overall trips being made by transit) varies by location in Oakville. Rather than express ridership as a mode split, the Town has chosen to describe the expected service in different corridors based on frequency of bus service, etc.(Ex. Near 407, downtown Oakville, etc) |

| Question | Response |
|---|---|
| Is the Town's plan going to improve the overall mode split in Oakville? | In some areas the mode split will rise to 25%, as a result of intensified development and transit supportive land use. Other areas will experience a mode split of 10-12%, which is related to changes in service levels. |
| What is the current mode split in Oakville today? | The average existing transit mode split, as reported in the Transportation Tomorrow Survey data (TTS) [collected in 2001] is between 7 and 8%, when GO Transit is included. |
| <i>Alternative Solutions</i> | |
| Is Lower Baseline going to be considered as an alternative solution? It appears that Dundas Street is the only other "Upgrade Capacity" solution. | Lower Baseline will be considered as an alternative solution. A widened Dundas Street was used as an example of a road system expansion alternative solution. |
| <i>Alternative Solutions – Assessment Criteria</i> | |
| The criteria Community Connectivity can be looked at from both the land use perspective and the transportation perspective. I feel this will be a very important part of the next phase of the project, when assessing the alternative solutions. | Comment noted. |
| <i>General</i> | |
| The Town of Milton is currently undertaking a Class EA for Lower Baseline. Has this been considered? | The Class EA relates to a reconstruction of Lower Baseline. This planned improvement will be added to the planning context for this Study. |

3. Next Steps

- The next Stakeholder meeting is scheduled for April 13 at 6:30 p.m.
- The next TAC meeting will be held in early June 2005 to discuss the results of the assessment of alternative solutions
- The first Public Information Centre is scheduled for mid-June 2005.

Meeting Adjourned

Appendix A
List of Participants

| TAC | |
|---------------------|---------------------------|
| Name | Agency/Affiliation |
| Andy Kwan | City of Mississauga |
| Jane DeVito | Conservation Halton |
| David Gale | Halton EEAC |
| John Sinnige | Halton EEAC |
| William Chan | Oakville Hydro |
| Dave Bloomer | Town of Oakville |
| Robert Thun | Town of Oakville |
| Angela Iannuzziello | Entra Consultants |
| Edward Soldo | Halton Region |
| Eric Hakomaki | Halton Region |
| Doug Corbett | Halton Region |
| Paul Attack | Halton Region |
| Joseph Choi | Halton Region |
| Mike Delsey | TSH |
| Colleen Goodchild | TSH |
| Charlotte Young | ENVision...synergy |

Appendix B
Presentation

NEW BURNHAMTHORPE ROAD

(Regional Road 27) Transportation Corridor
and Potential Future Bridge Crossing of
Sixteen Mile Creek Class EA

TAC Meeting #2
April 12, 2005

Study Organization

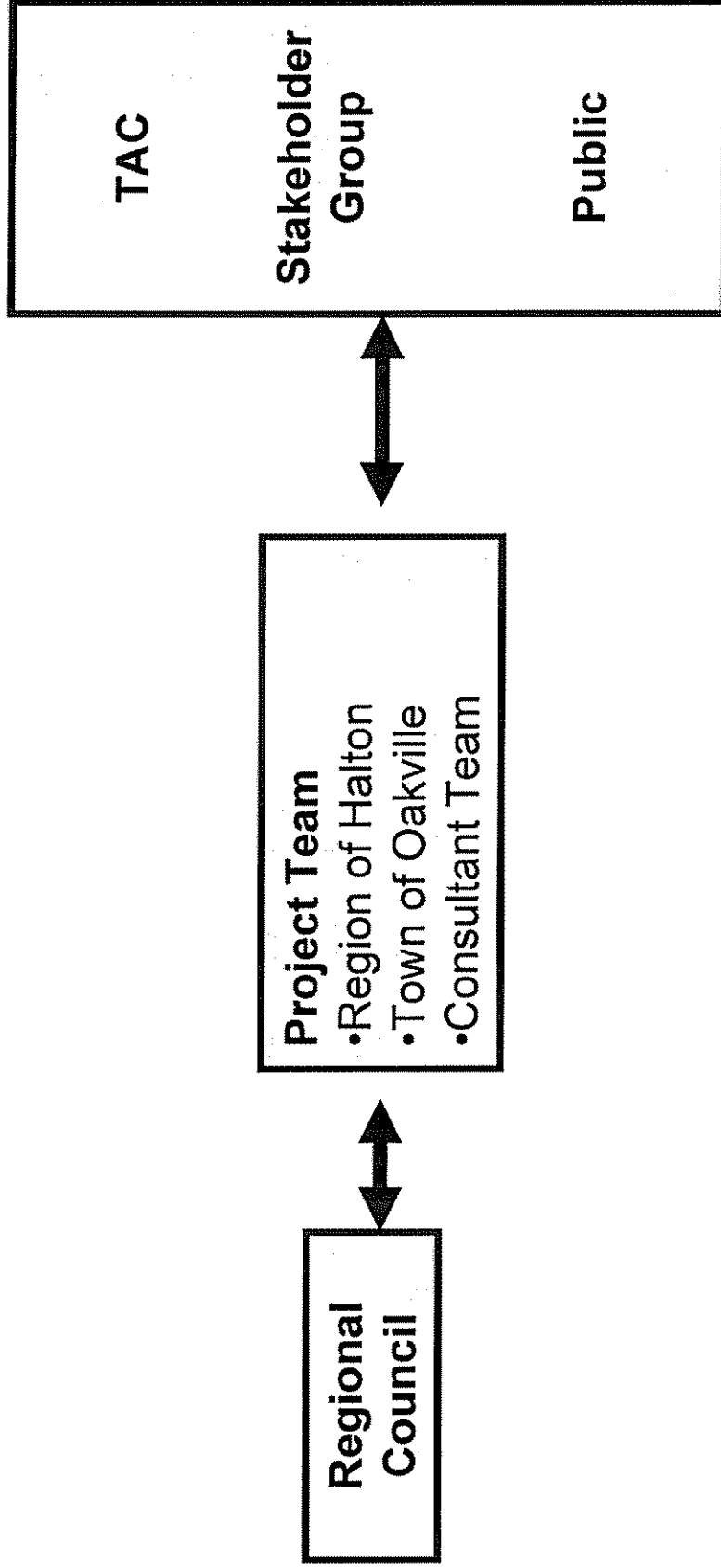

—

Study Approach

- Municipal Class EA process
- Canadian Environmental Assessment process
- The Region of Halton and Town of Oakville are working together to co-ordinate the Burnhamthorpe Road Class EA and the North Oakville Secondary Planning Process

1. Identification of the problem or opportunity

2. Assessment and evaluation of alternative solutions

3. Assessment and evaluation of the alternative design concepts for the preferred solution

4. Documentation in an Environmental Study Report

5. Project Implementation

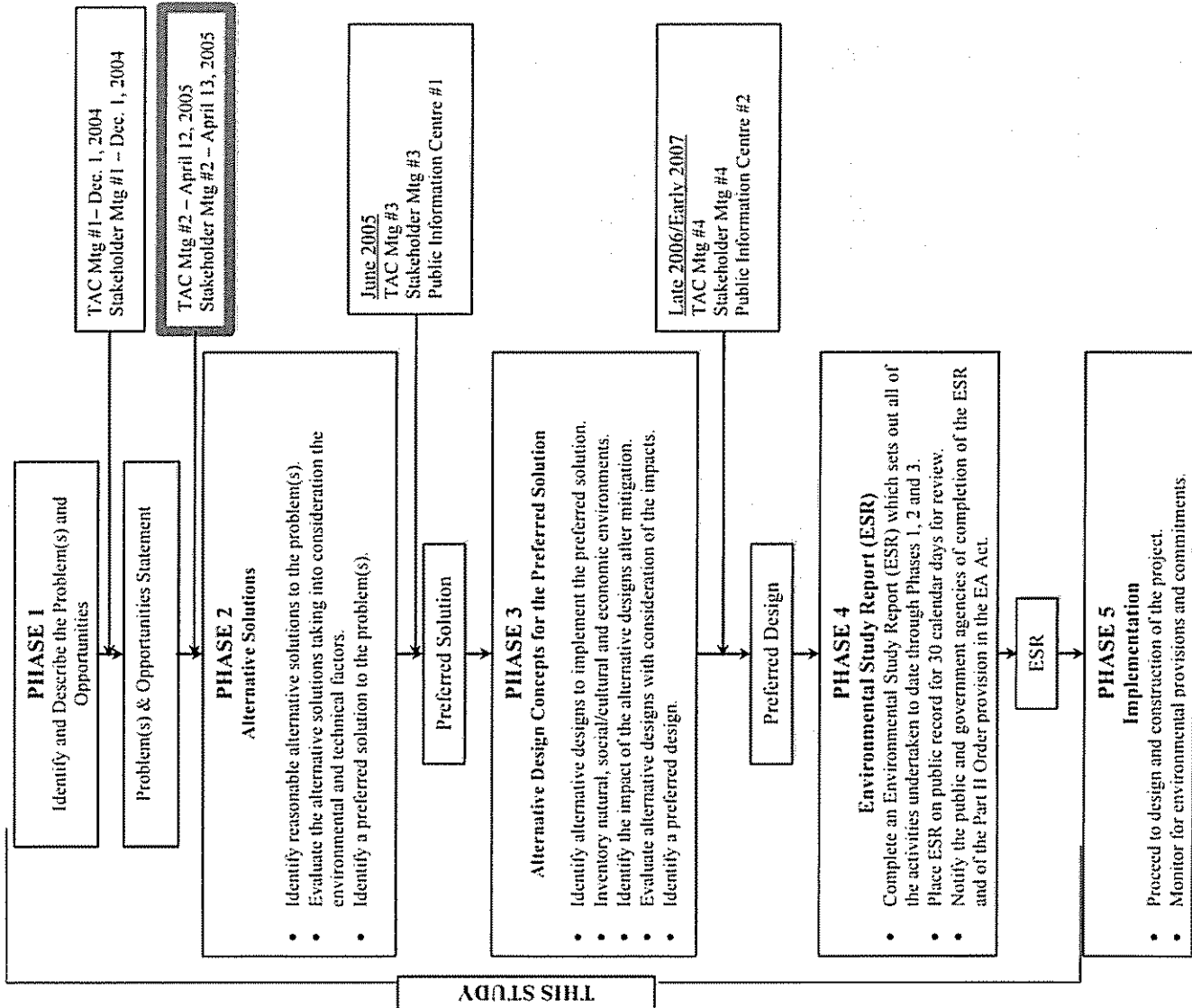

Study Area

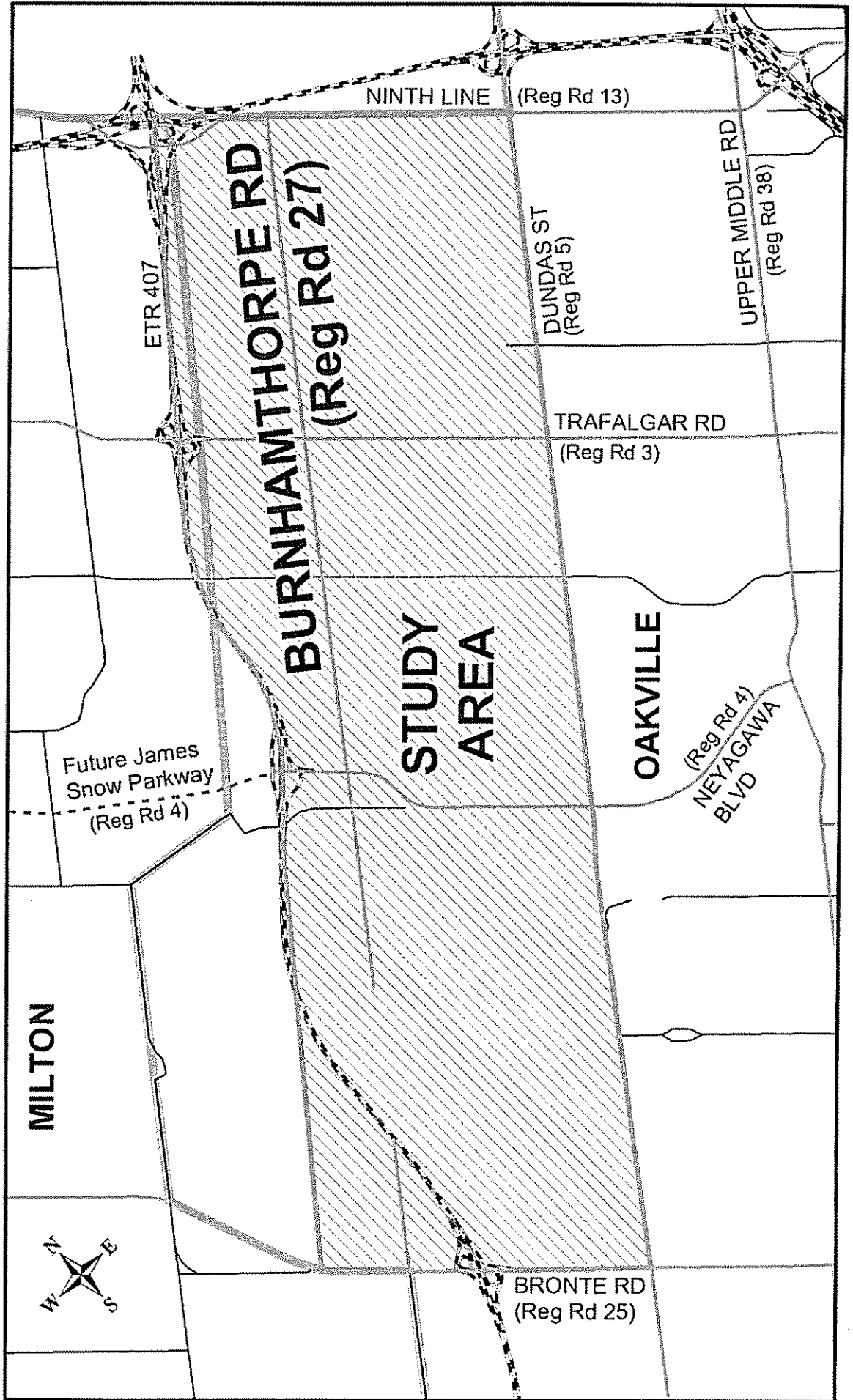

Recap of Stakeholder Group Meeting #1

- Existing Conditions Overview
 - Previous Studies
 - Natural, Social/Cultural/Economic Environment
 - Transportation
- Key Study Issues
- Potential Improvement Opportunities
- Assessment Criteria for Alternative Solutions
(Deferred)

Preliminary Identification of Study Issues

- Provision for all modes of travel (transit, **carpooling**, autos, cyclists, pedestrians)
- Provision of safe access to adjacent existing and planned developments
- Consideration of impacts on environmental features
- Consideration of:
 - Aesthetics;
 - Streetscaping;
 - Safety;
 - **Air Quality**;
 - Noise; and
 - Other community issues.
- Transit opportunities
- Future travel demand
- **Location of potential Sixteen Mile Creek crossing impacts**
- **Co-ordination and compatibility with the Secondary Planning process**
- **Consideration of provincial policies/guidelines**

Planning Context – What’s new

- Greenspace protection – MNR
 - Greater Golden Horseshoe Growth Plan – MPIR
 - Co-ordination with Town of Oakville’s Secondary Planning Process
 - Population and employment forecasts
 - Transit forecasts/infrastructure requirements
-

Planning Context - Greenspace Protection in North Oakville, MNR

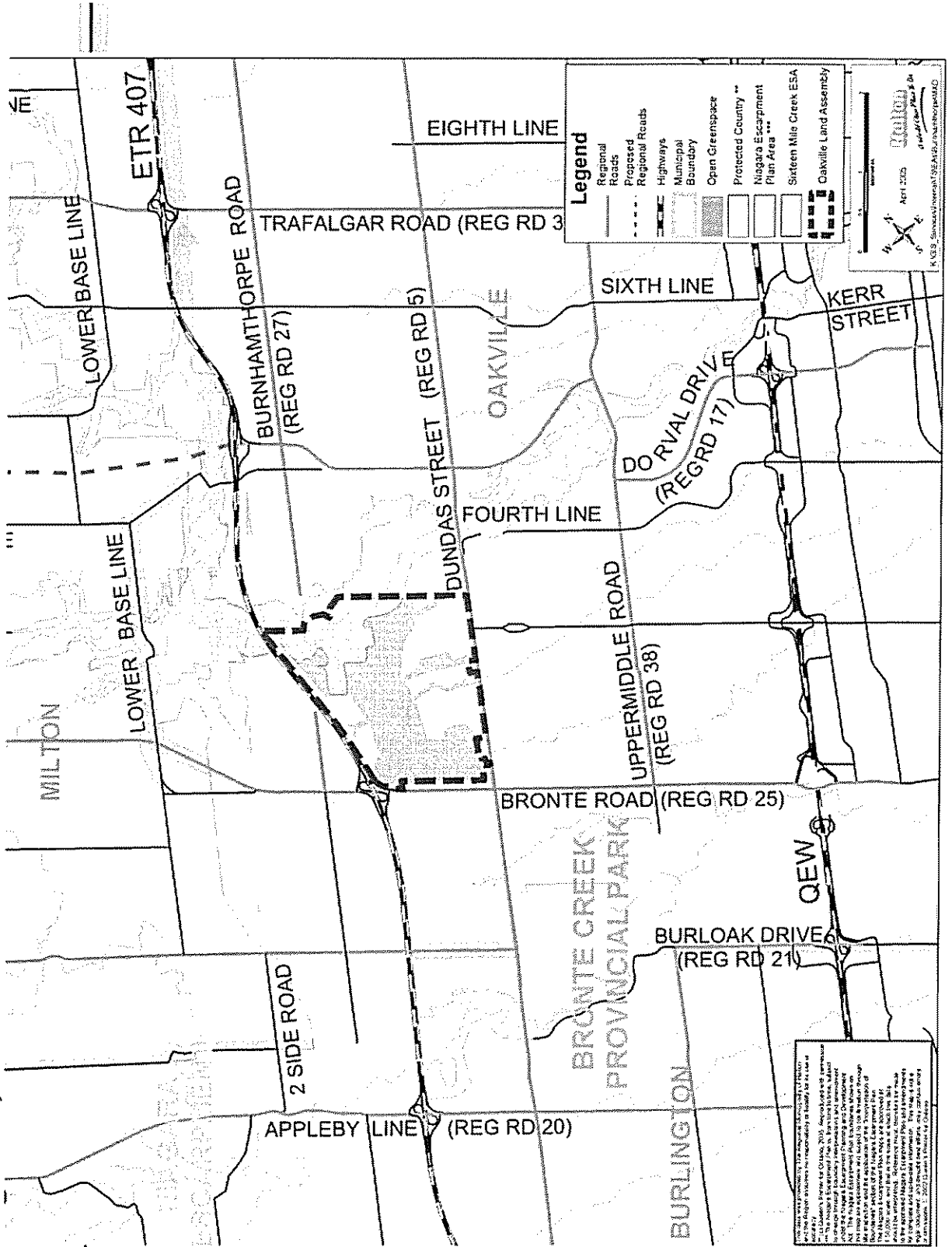

Map prepared by [Name] for the City of Oakville, 2025. All rights reserved. This map is for informational purposes only and does not constitute a contract or warranty of any kind. The City of Oakville is not responsible for any errors or omissions on this map. The user assumes all responsibility for the use of this map. The City of Oakville is not responsible for any damages or losses resulting from the use of this map. The City of Oakville is not responsible for any claims or liabilities arising from the use of this map. The City of Oakville is not responsible for any legal actions or proceedings arising from the use of this map. The City of Oakville is not responsible for any consequences or results arising from the use of this map. The City of Oakville is not responsible for any actions or inactions arising from the use of this map. The City of Oakville is not responsible for any decisions or judgments arising from the use of this map. The City of Oakville is not responsible for any outcomes or results arising from the use of this map. The City of Oakville is not responsible for any effects or impacts arising from the use of this map. The City of Oakville is not responsible for any changes or modifications arising from the use of this map. The City of Oakville is not responsible for any updates or revisions arising from the use of this map. The City of Oakville is not responsible for any deletions or removals arising from the use of this map. The City of Oakville is not responsible for any additions or insertions arising from the use of this map. The City of Oakville is not responsible for any alterations or amendments arising from the use of this map. The City of Oakville is not responsible for any cancellations or terminations arising from the use of this map. The City of Oakville is not responsible for any suspensions or interruptions arising from the use of this map. The City of Oakville is not responsible for any delays or postponements arising from the use of this map. The City of Oakville is not responsible for any cancellations or terminations arising from the use of this map. The City of Oakville is not responsible for any suspensions or interruptions arising from the use of this map. The City of Oakville is not responsible for any delays or postponements arising from the use of this map.

Growth Plan - MPIR

| Population | | | |
|---------------------------------------|---------|---------|---------|
| Projection | 2011 | 2021 | 2031 |
| Region of Halton – previous estimates | 498,000 | 592,300 | N/A |
| MPIR Growth Plan | 500,000 | 620,000 | 750,000 |

| Employment | | | |
|---------------------------------------|---------|---------|---------|
| Projection | 2011 | 2021 | 2031 |
| Region of Halton – previous estimates | 251,460 | 307,900 | N/A |
| MPIR Growth Plan | 270,000 | 330,000 | 370,000 |

Transportation Issues & Opportunities

Identification of Need

- A review of existing conditions indicates:
 - East-west travel in the Study Area is approaching capacity
 - Individual east-west facilities (roadways) in the study area are already operating at or beyond capacity.

 - Even with the implementation of planned road transportation improvements in the study area (e.g. Dundas St widening, James Snow Parkway extension) capacity deficiencies are expected in the long term

 - Town of Oakville future transit ridership targets will reduce, but not eliminate the need for road capacity improvements
-

Existing Transportation Conditions

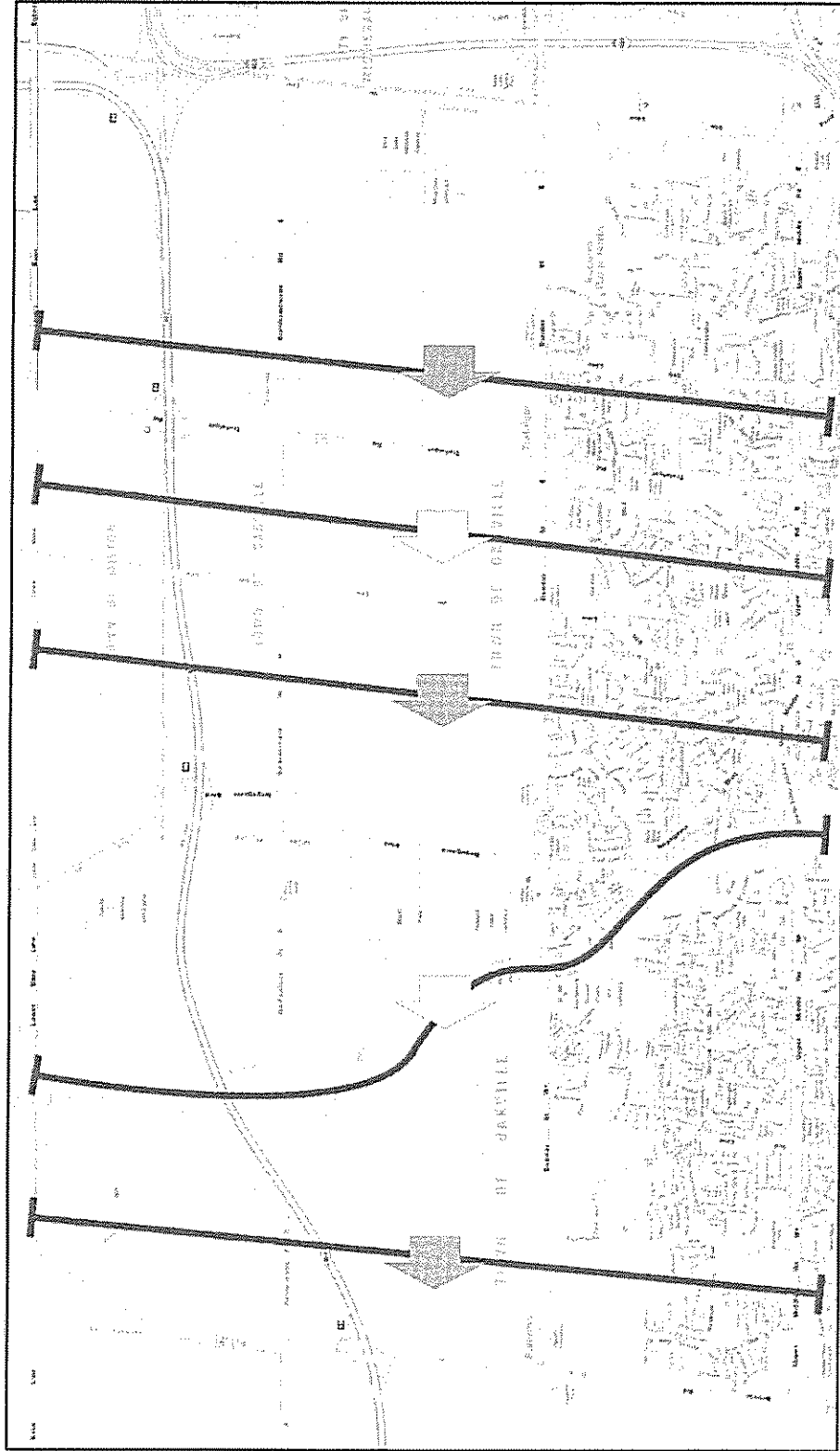

Legend
▬ peak direction flow crossing screenline
■ v/c > 0.90
□ v/c 0.80 - 0.90
○ v/c < 0.80

Screenline Analysis [Full Screenline]
2001 P.M. Peak Hour

2021 Transportation Conditions

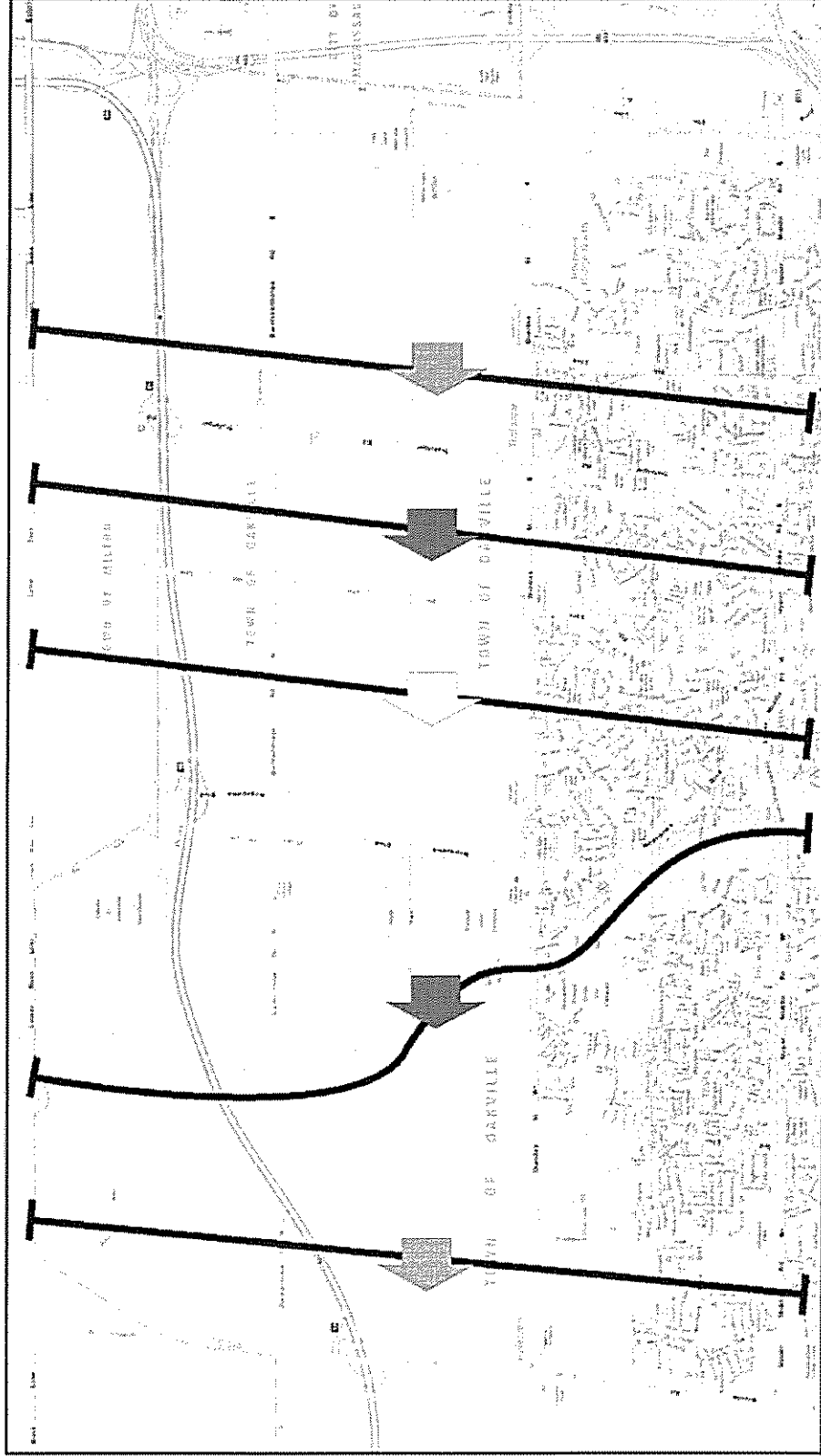

Legend
 peak direction flow crossing screenline
 vic > 0.90
 vic 0.80 - 0.90
 vic < 0.80

Screenline Analysis [Full Screenline]
 Best Planning Estimate Land Use
 2021 Planned Network - Existing
 Burnamthorpe Road

Transportation Conditions – Full Build-out of North Oakville

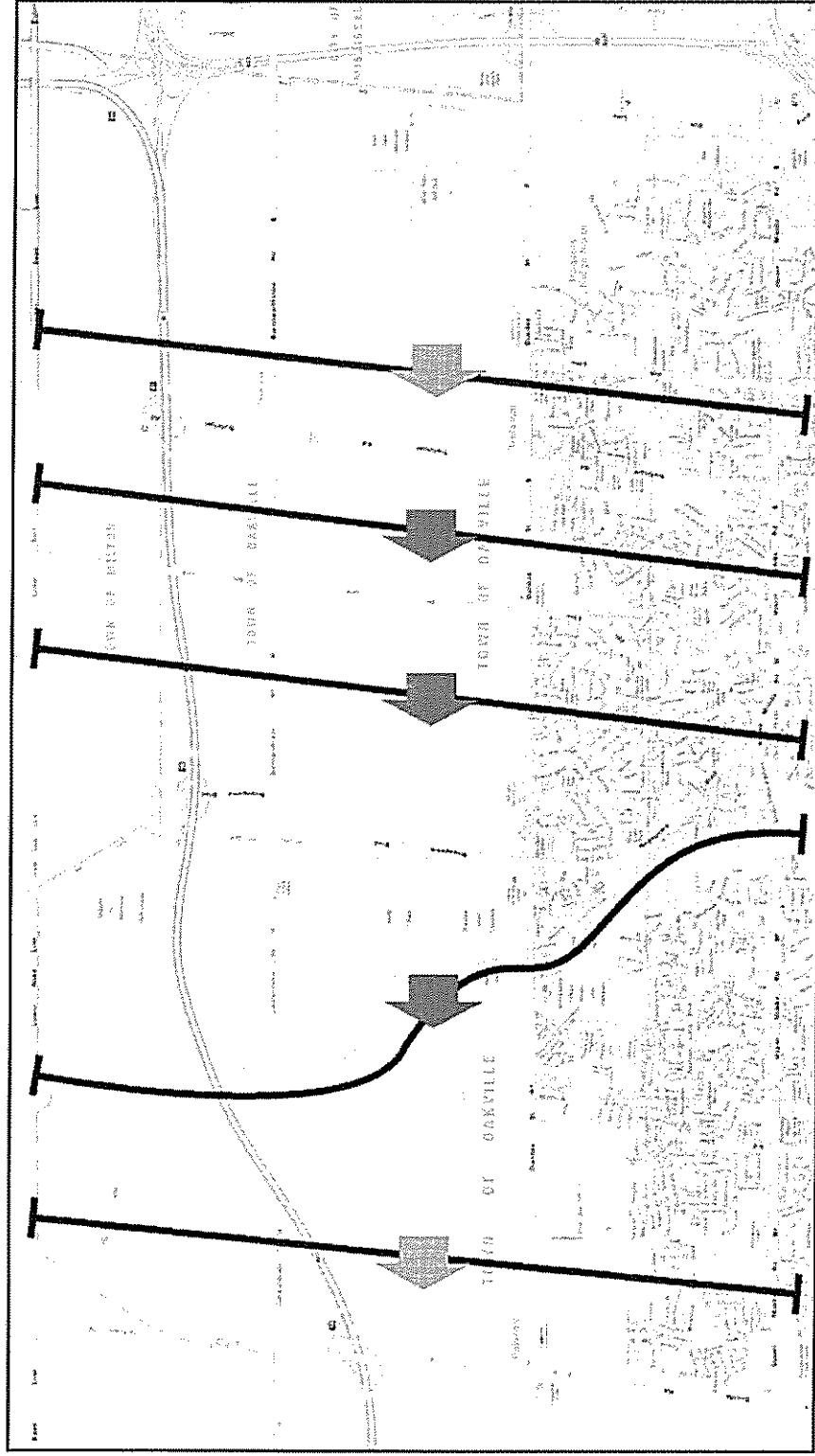

Legend
 → peak direction flow crossing screenline
 thick line v/c > 0.90
 medium line v/c 0.80 - 0.90
 thin line v/c < 0.80

Screenline Analysis [Full Screenline]
 Full Build Out of North Oakville
 2021 Planned Network - Existing
 Burnhamthorpe Road & James Snow Parkway
 Extended to Neyagawa Boulevard

Screenline Volume Assessment

Without Highway 407

| Screenline | PM Peak Hour Westbound Direction | | | | | | | | | | | |
|----------------------------------|----------------------------------|----------|------|--------|--|------|--------|----------|---|--------|----------|-----|
| | Existing (2001) | | | | 2021 | | | | Full Build-out of N. Oakville | | | |
| | Volume | Capacity | v/c | Volume | Capacity | v/c | Volume | Capacity | v/c | Volume | Capacity | v/c |
| East of Bronte Road (RR 25) | 2,538 | 3,250 | 0.78 | 3,208 | 5,420 | 0.59 | 2,645 | 5,420 | 0.49 | | | |
| Sixteen Mile Creek | 3,649 | 4,100 | 0.89 | 4,968 | 4,570 | 1.09 | 5,189 | 4,570 | 1.14 | | | |
| East of Neyagawa Blvd (4th Line) | 3,678 | 4,950 | 0.74 | 5,293 | 5,420 | 0.98 | 6,227 | 5,420 | 1.15 | | | |
| East of 6th Line | 4,131 | 4,950 | 0.83 | 6,047 | 5,520 | 1.10 | 6,394 | 5,520 | 0.99 | | | |
| East of Trafalgar Road | 3,856 | 4,950 | 0.78 | 4,977 | 5,870 | 0.85 | 5,129 | 5,870 | 0.87 | | | |
| | Existing road network | | | | Existing Burnhamthorpe Rd Planned road improvements | | | | Existing Burnhamthorpe Rd Planned road improvements Extension of JSP to Neyagawa Blvd | | | |

LEGEND

 v/c > 0.90

 v/c 0.80 - 0.90



 v/c < 0.80

Screenline Volume Assessment

With Highway 407

| Screenline | PM Peak Hour Westbound Direction | | | | | | | | | | | |
|----------------------------------|----------------------------------|----------|------|--------|--|------|--------|----------|---|--------|----------|------|
| | Existing (2001) | | | | 2021 | | | | Full Build-out of N. Oakville | | | |
| | Volume | Capacity | v/c | Volume | Capacity | v/c | Volume | Capacity | v/c | Volume | Capacity | v/c |
| East of Bronte Road (RR 25) | 6,924 | 9,050 | 0.77 | 7,327 | 10,820 | 0.68 | 7,331 | 10,820 | 0.68 | 7,331 | 10,820 | 0.68 |
| Sixteen Mile Creek | 8,034 | 9,900 | 0.81 | 9,086 | 9,970 | 0.91 | 9,875 | 9,970 | 0.99 | 9,875 | 9,970 | 0.99 |
| East of Neyagawa Blvd (4th Line) | 8,314 | 10,750 | 0.77 | 9,257 | 10,820 | 0.86 | 10,650 | 10,820 | 0.98 | 10,650 | 10,820 | 0.98 |
| East of 6th Line | 8,759 | 10,850 | 0.81 | 10,011 | 10,920 | 0.92 | 10,817 | 10,920 | 0.99 | 10,817 | 10,920 | 0.99 |
| East of Trafalgar Road | 8,513 | 10,950 | 0.78 | 8,241 | 11,270 | 0.73 | 8,431 | 11,270 | 0.75 | 8,431 | 11,270 | 0.75 |
| | Existing road network | | | | Existing Burnhamthorpe Rd Planned road improvements | | | | Existing Burnhamthorpe Rd Planned road improvements Extension of JSP to Neyagawa Blvd | | | |

LEGEND

-  v/c > 0.90
-  v/c 0.80 - 0.90
-  v/c < 0.80

Town of Oakville

Transportation Master Plan (April, 2004)

Transit Component of TMP comprises:

- ~ Transit corridors and service
- ~ Places to connect

Based on draft NOSP land use, expanded technology, service and fare coordination

- ~ Customer focused marketing, education and promotion

Roadway infrastructure based on combined needs for auto, bus, cycling, and pedestrian users



OAKVILLE

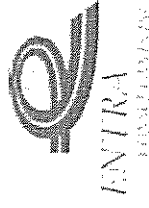

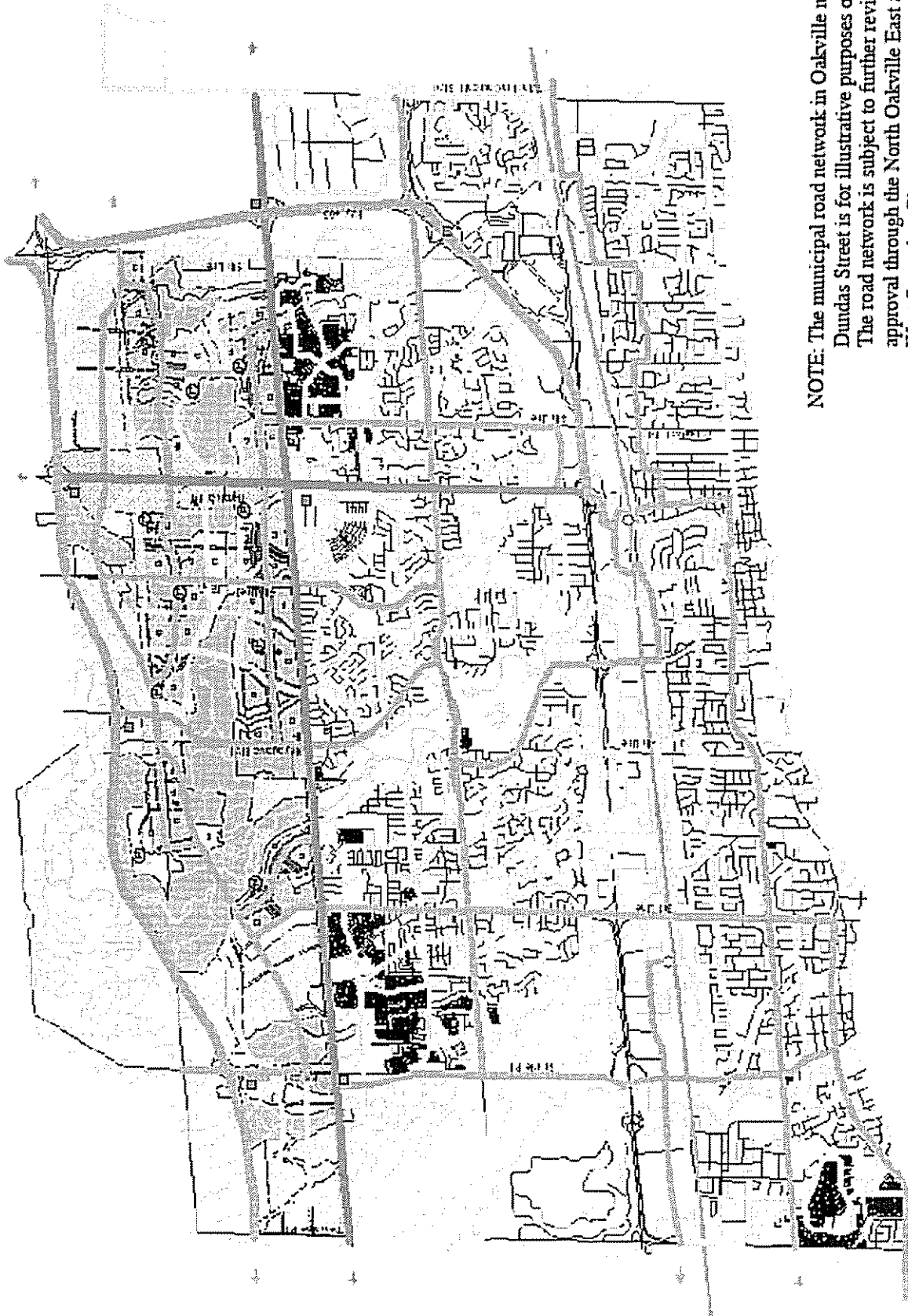

NOTE: The municipal road network in Oakville north of Dundas Street is for illustrative purposes only. The road network is subject to further review and approval through the North Oakville East and West Secondary Plans process.



OAKVILLE

Oakville TMP - Transit Plan



Transit Strategy

Secondary Corridors

- ~ Operate on the grid network of streets
- ~ About every 7 to 10 minutes
- ~ Connect to the schools, to shopping, to urban core areas
- ~ Low floor accessible comfortable vehicles
- ~ Transit priorities in congested areas
- ~ Connecting to community services

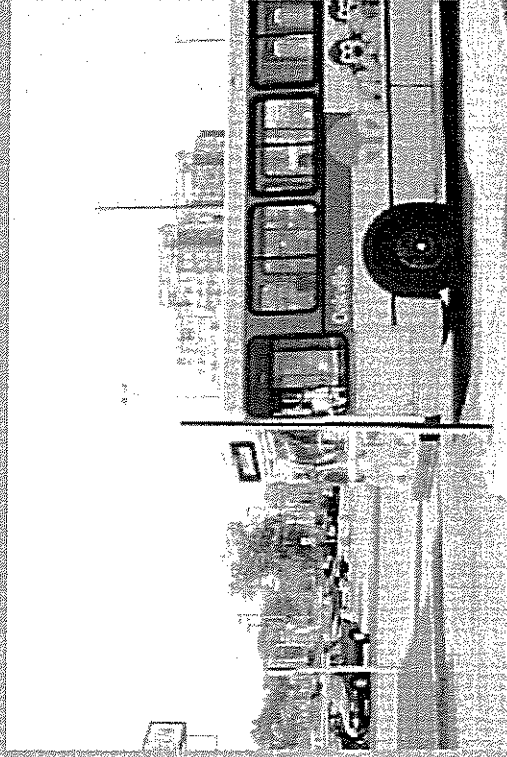
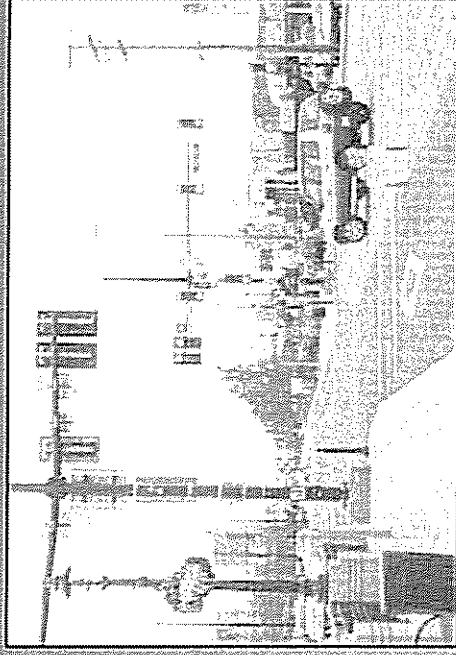

OAKVILLE



ENTRA
LIVING/WORKING

Transportation Issues & Opportunities

Identification of Need - Summary

- Provincial Policy Context
 - Identified increased population and employment targets for Halton Region, a share of which would be accommodated within the Town of Oakville
 - North Oakville Secondary Plan
 - Planning ongoing in coordination with this Study
 - Transportation infrastructure required to support planned land use
 - Analysis Results
 - Forecasts indicate the need for transportation system capacity improvements in an east-west direction across the Study Area
 - Alternative Solutions
 - A range, or combination of alternative solutions may be necessary to address future transportation need
-

Preliminary Identification of Alternative Solutions

- **Do Nothing**
 - (Base Case for comparison)

- **Road System Expansion**
 - Upgrade capacity of adjacent roads
 - (Ex. Dundas Street widened from 4-6 lanes to 8-10 lanes)
 - Upgrade capacity of Burnhamthorpe Road
 - Increase transit services/facilities (HOV/bus lanes, Reserved Bus Lanes, higher order transit)

Note: If Burnhamthorpe Road capacity improvements are the recommended solution, alternative routes will be identified, assessed and evaluated in the next phase of study

Preliminary Identification of Alternative Solutions

- **Transportation System Improvements (non-expansion)**
 - Reduce auto usage using Transportation Demand Management Measures (ex. Regional TDM strategy)
 - Maximize existing road capacities (Transportation Systems Management)
 - Increase transit services/facilities (ex. Service increases that do not trigger road improvements, signal priority, etc)
-

Preliminary Identification of Assessment Criteria

TRANSPORTATION

- Accommodation of future auto demand
- Travel safety
- Emergency service
- Transportation network compatibility
- Transit network connectivity
- Commercial goods movement
- Accommodation of pedestrian/cyclists

ENGINEERING

- Construction impacts
- Utility/service relocations
- Property Requirements
- Costs
 - Capital
 - Operating and Maintenance

Preliminary Identification of Assessment Criteria

NATURAL ENVIRONMENT

- Watercourses/fisheries
- Vegetation and woodlots
- Wildlife
- Wetlands/marsh areas
- Fluvial geomorphology conditions
- Groundwater/surface water/drainage
- ■ *Natural Heritage system connectivity*
- *Compatibility with North Oakville subwatershed studies*

Preliminary Identification of Assessment Criteria

SOCIAL/CULTURAL/ECONOMIC ENVIRONMENT

- Proximity impacts (noise impacts, aesthetics)
 - Traffic infiltration
 - Residential property impacts
 - Commercial property impacts
 - Compatibility with existing/future land uses/plans
 - Consistency with Official Plan policies
 - Archaeological resources
 - Built Heritage resources & rural character
 - Recreational opportunities
 - Future development/redevelopment potential
 - Accessibility
 - Community Connectivity & *Integration*
 - Air quality
 - Accommodation of pedestrians and cyclists
-

Working Session

Transportation Issues & Opportunities
(Refer to workbook)

Working Session

Potential Alternative Solutions
(Refer to workbook)

Working Session

Alternative Solutions Assessment Criteria
(Refer to workbook)

Extra Slides

—

Previous Studies

- Halton Functional Road Network and North Halton Transportation Study, May 1999
 - Halton Region Transportation Master Plan November 1999 and June 2004
 - Making Connections: Transit for Halton, October 2002
 - Region of Halton Road Needs Study, 2003
 - Draft Oakville Transportation Master Plan, February 2004
 - Draft North Oakville East and West Secondary Plans, February 2004
 - Draft Growth Plan, Province of Ontario, 2005
 - Greenbelt Plan, Province of Ontario, February 2005
-

Existing Road Network

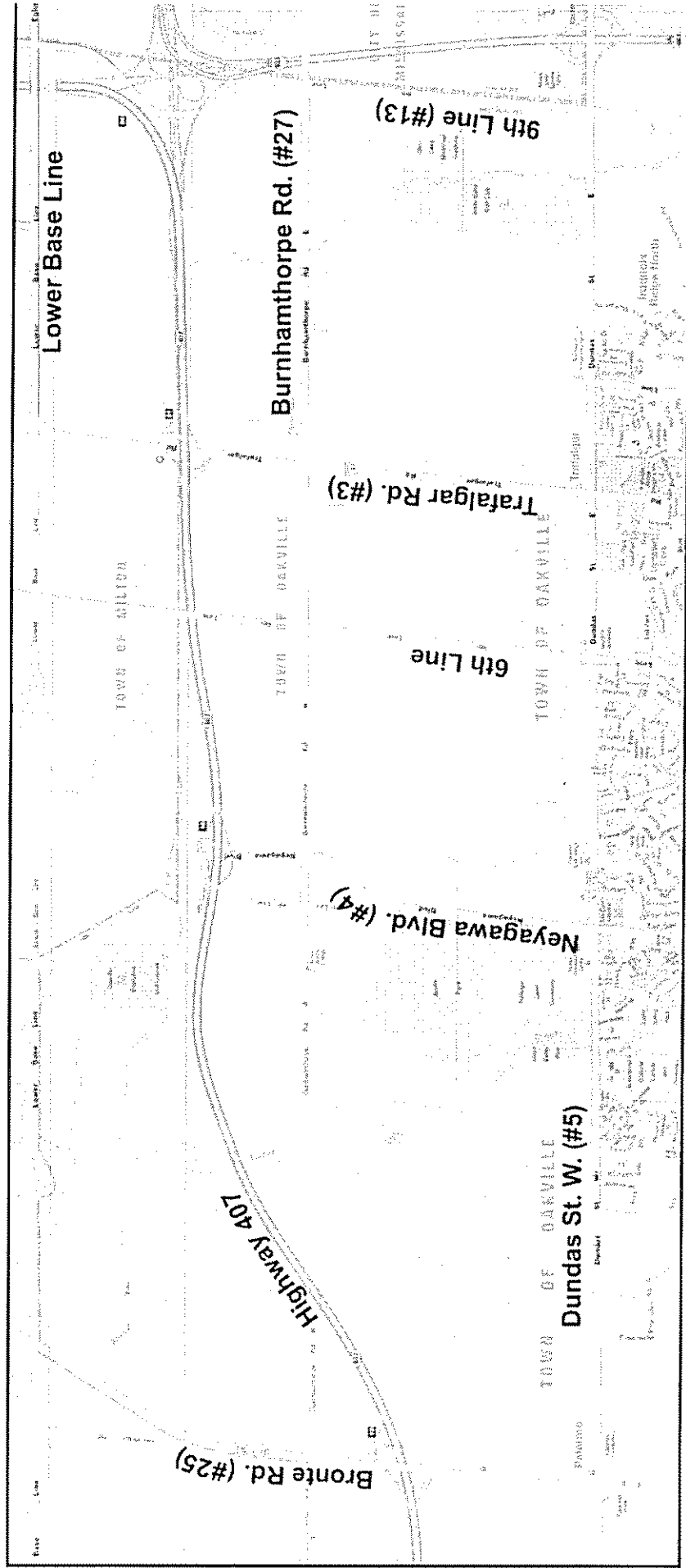

2004 ADT Volumes (24 hr)

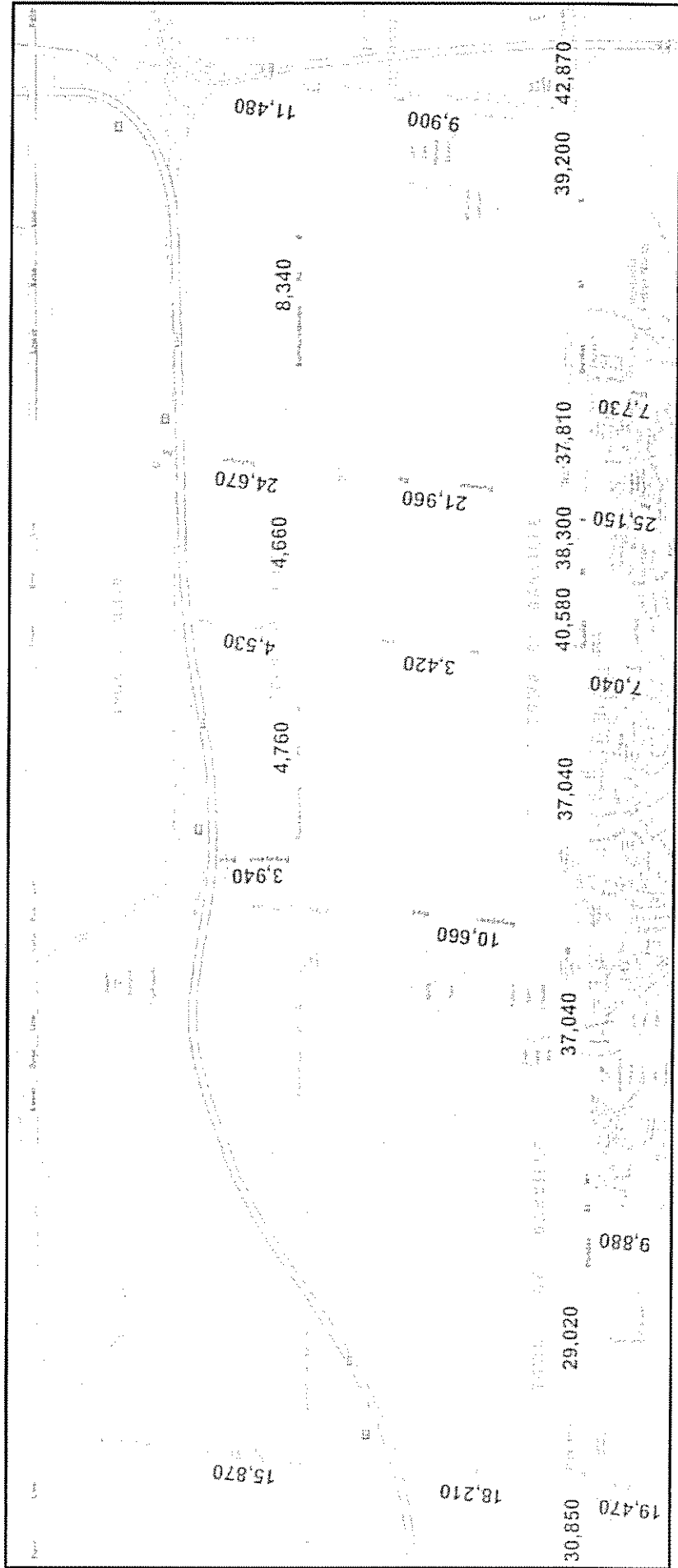

Halton Region Road Improvement Plan

(Source: TMP)

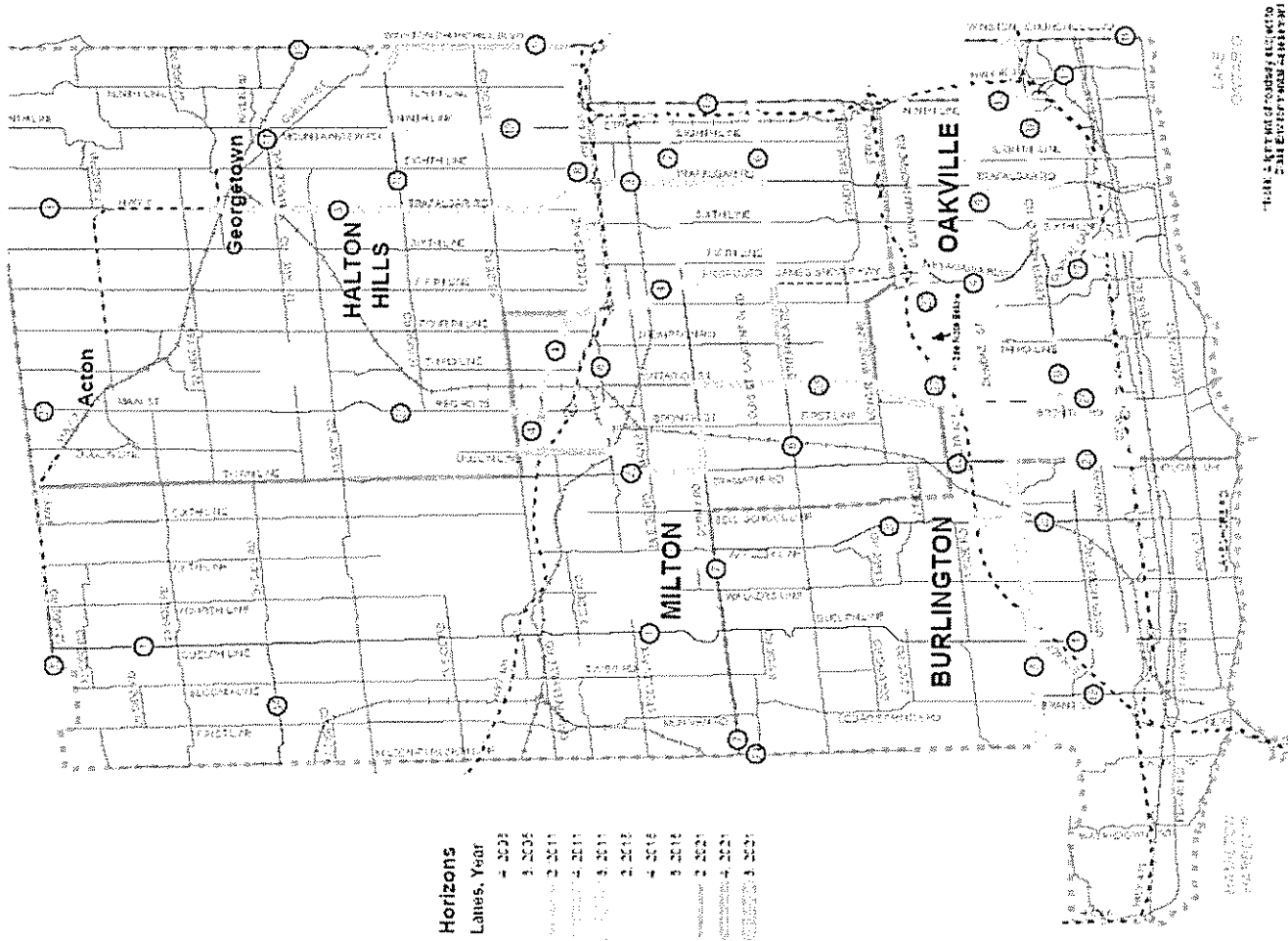

Figure 4
Required Lane Widening by Time Horizon
(2004-2021)